

## Instructions for use



## Starter Set for Harvester Ants

# **Instructions for use**

This starter set is suitable, for example, for various species of the Messor genus. One of the two farms is intended for storing the ant bread and should therefore be kept completely dry to prevent any grains/seeds stored there by the ants from germinating or becoming mouldy.

## **Step 1**

### **Search for a suitable location**

In order not to expose the ants to unnecessary vibrations and temperature fluctuations, a suitable and stable site should be selected.

Attention:

- do not place near windows (sunlight)
- do not place near radiators
- do not place on vibrating surfaces
- do not place near music equipment
- do not place near noisy machines
- do not place over electrical appliances
- do not place in a room with strong odours (e.g. kitchen)
- do not place in a smoking room

## Step 2

### **Control**

Check the complete contents of the kit to make sure everything is in stock.

### **Content:**

- 1x ANTCUBE - Arena 20x20x10 - flat
- 1x Ant arena frame 20x20
- 1x cover 20x20 + fixing corners
- 2x ANTCUBE - Ant farm - M - 20x20 - standing
- 1x Digfix plate 20x20 - M
- 1x 1m tube transparent 14/10 mm
- 2x ANRed foil 20x20 - self-adhesive
- 1x Substrate - desert - 1 Kg
- 2x Grid insert - 50mm - stainless steel
- 1x insert - 27mm - stainless steel
- 1x Grid cap - 10mm
- 1x Basin connector for hole 27 and hose 10-16 mm - M25
- 1x Formicarium nut M25 - grey
- 1x Food dispenser 2ml - dosable
- 1x Drinking trough 2ml - 360 degrees
- 1x Bowl clear 1x20 - sponge
- 1x Mini thermo-hygrometer analogue - display - hanging
- 1x Ant outbreak protection oil 10ml
- 1x Tweezers spring steel - wide - soft
- 1x Tweezers plastic transparent
- 1x pipette 3ml
- 1x Hand magnifier - 2-fold - 30mm
- 1x Food mix set - for grain collectors
- 1x Foam wiper 150x18x2,5mm
- 1x Photo back wall - desert - 20x10

**Note:** The Digfix plates can be used in the fully transparent farms. Alternatively, however, the Soil - Desert can be used to fill the farms.

### Step 3

#### Assembly

- First, fill the **ANTCUBE arena 20x20x10 - flat** with the **substrate - desert - 1 kg** mixture. The layer should **not be higher** than 1-2mm, otherwise there is a risk that the ants will dig themselves in and not use the farm or nest area intended for them.



- The **basin connector for hole 27 and hose 10-16 mm - M25** is now screwed to the arena. To do this, the **0.5 m transparent 14/10 mm hose** is inserted into the connector and screwed tightly with the **formicarium nut M25 - grey**. We cut a piece from the other end of the hose. This serves as a connector between the individual ant farms.

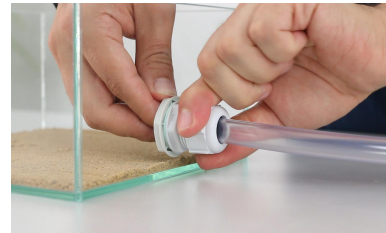

- From the other end of the hose we cut off a piece. This serves as a connector between the individual ant farms. The end of the hose is now pushed onto the socket of the farm and connected to each other. We connect the two farms with the cut short hose and push the ends onto the sockets of the farms.



- With the existing **grid insert - 27mm - stainless steel** and the **grid cap - 10mm - stainless steel**, the still open sockets of the farm and the arena are closed.

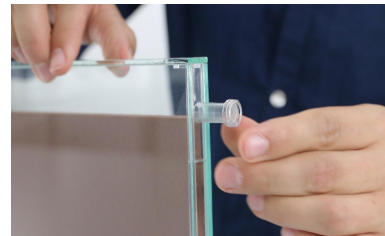

- With the help of the **plastic pipette 3ml**, the **drinker 2ml - 360 degrees** is filled and food is put into the food **dispenser 2ml - dosable**. In the **bowl clear 1x20 - sponge** we put e.g. a mealworm as food.



These are then placed in the front area of the arena. This facilitates food control and makes it easier to see if the containers need to be cleaned.

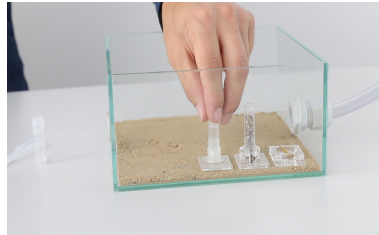

- When everything has been placed correctly, the **mini thermo-hygrometer analogue - display** - is attached to the underside of the frame (**Ameisenarena frame 20x20**) in a **hanging position**. For this purpose, the protective film of the adhesive surface must be removed.

**IMPORTANT:** The thermo - hygrometer must be attached to the inside of the frame and **not to the outside of the frame**, otherwise the frame will not fit on the arena. There is only one attempt at fixing, as the glue holds very well and it is difficult to remove it later.



- The **ant escape protection oil 10ml** is now applied to the inner frame. For this we use the **foam wiper 150x18x2.5mm**. Alternatively, a household cloth or your own finger can be used. The layer should only be applied very thinly!

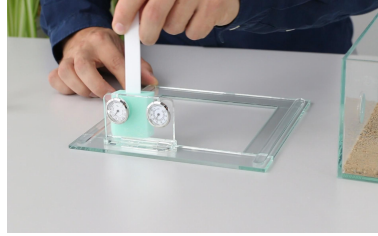
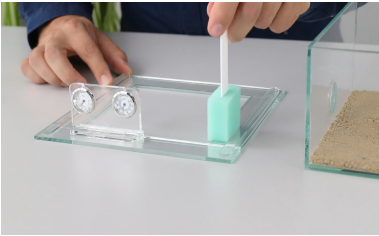

- The frame is placed on the rubberised rim of the arena. Please make sure that the frame is securely closed to the arena.



**The arena is now safe and the animals can no longer escape through the oil!**

If required, the supplied **ant arena cover 20x20 + fixing corners**, with the two exchangeable inserts **grid insert - 50mm - stainless steel** can of course also be placed on the arena frame. The grid insert ensures a good air exchange.



If necessary, the **ANTCUBE - Red Film 20x20 - self-adhesive** can be placed on the front area of the farm to give the ants an underground feel and the chance to build closer to the glass.

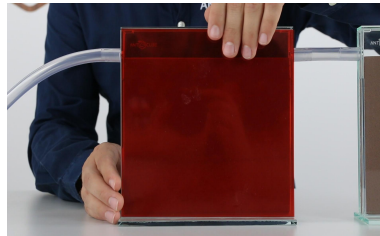



## Step 4

### **Settling the colony**

Before we put the animals in, we have to humidify the farm. To do this, we remove the formicarium cap at the top right of the farm. The pipette is then inserted through the socket and the Digfix is moistened with water. When filling the farm for the first time without the animals, you can also simply remove the farm lid.

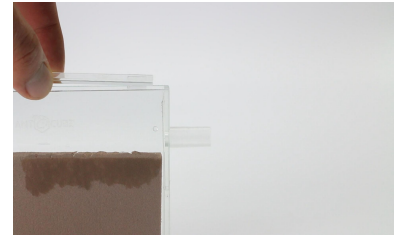
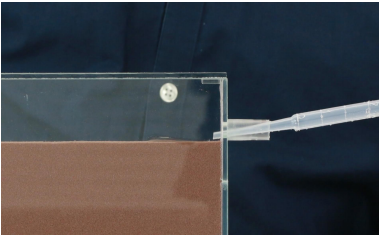

Now remove the plug from the nest tube and place it in the arena so that the ants can get used to their new environment and move in. When all the ants have moved in, the empty tube can be removed.



### Explanation of individual components:

- The **arena** serves to ensure that the animals can supply themselves with food and water accordingly. Furthermore, they can take out their waste there.
- The **frame** is placed on the arena as a break-out protection.
- The **cover** is an additional break-out protection and the holes can be closed with **plugs**.

The **farm** serves as a nesting area for the animals, where the queen and about 90% of the workers stay with the brood.

- The **hose connector** is suitable for the transition from the arena to the farm and is important for the transport of food and waste.

The sand-loam **substrate** is suitable for filling the arena so that the floor is covered.

The **thermo-hygrometer** is used to monitor the temperature and humidity in the arena.

- The **feed dispenser 2ml - dosable** is suitable for the grain mixtures as well as carbohydrate and protein powders.
- The **break-out protection oil** additionally serves as protection on the frame. The animals find no adhesion through the oil film and cannot run over the protection.
- The **tweezers plastic transparent are used** for gripping solid objects and the **tweezers spring steel - wide - soft** are used for gripping ants so as not to injure them.



- With the **hand magnifier - 2x - 30mm** we can observe small objects well.



**Hint:**

With the Digfix plate, the ants can create their own chambers and passages according to their own needs. These passages do not collapse and are very easy for the ant keeper to see.

Most of the time, the ants tear out small and also larger pieces from the Digfix plate to create the necessary space for themselves and to build.

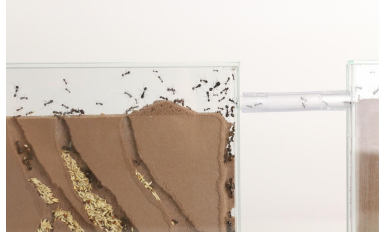

On our website there is a helpful video specifically for the ANTCUBE Starter Set for Harvest Ants (Messor spec.):



Manufacturer:

ANTSTORE  
Selerweg 41  
D-12169 Berlin

Tel.	+49 30 766 870 51
Fax	+49 30 766 870 54

Email	<a href="mailto:verkauf@antstore.de">verkauf@antstore.de</a>
URL	<a href="http://www.antstore.de">www.antstore.de</a>